



Fixture specification

MODEL #: **OFR**

STYLE / LAMP / LAMP / WATTAGE / KELVIN / BALLAST / FINISH / LENS / ACCESSORIES / SIZE / COMPLIANCE
QTY TYPE DETAIL

PROJECT : _____ TYPE : _____ NOTE : _____

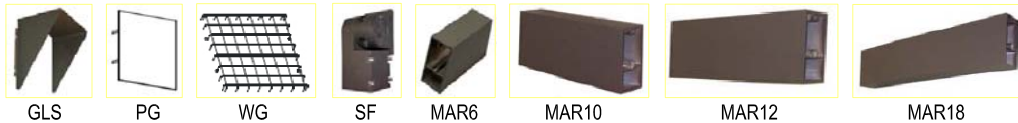
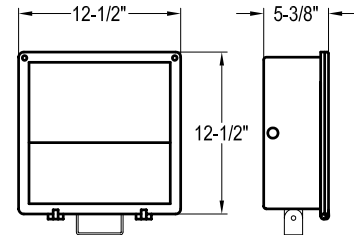
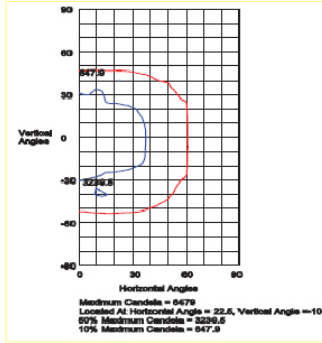

Light Source

Type	High Pressure Sodium					Metal Halide					LED		Induction	
Wattage	35	50	70	100	150	50	70	100	150	175	7.5	15	40	80
Quantity	1	1	1	1	1	1	1	1	1	1	-	2/3	1	-

Standard Features

BASE	Die Cast Aluminum Hinged Top Frame 1/2" Coin Plugs with O-rings for Conduit and/or Photo Cell Small Yoke Mount	FINISH	Bronzitone	LENS	Tempered Flat Clear Glass
LISTING & RATING	UL Listed Wet Location	LAMP	LED - 2700K Induction - 5000K	REFLECTOR	Aluminum Smooth
		ELECTRICAL/INDUCTION and LED	Electronic Ballast High Power Factor 120V-60Hz AC	ELECTRICAL/HID	Magnetic Ballast HPS 35-150/NPF/120V MH 50/HPF/120-277V All Others Wattages: HPF/120-208-240-277V

Special options

Please Note: Standard Features May Change if Fixtures are Ordered with Special Option(s).

BALLAST	<input type="checkbox"/> DV 120/277 Volt <input type="checkbox"/> HPF High Power Factor <input type="checkbox"/> V 277 Volt	COMPLIANCE	<input type="checkbox"/> ES Energy Star	<input type="checkbox"/> MAR10 10" Mounting Arm, Gasket & Hardware
FINISH	<input type="checkbox"/> FCU Custom	ACCESSORIES	<input type="checkbox"/> EPC External Photocell <input type="checkbox"/> GLS Glare Shield <input type="checkbox"/> IPC Internal Photocell <input type="checkbox"/> LY Large Yoke <input type="checkbox"/> PG Polycarbonate Guard <input type="checkbox"/> MAR6 6" Mounting Arm, Gasket & Hardware	<input type="checkbox"/> MAR12 12" Mounting Arm, Gasket & Hardware <input type="checkbox"/> MAR18 18" Mounting Arm, Gasket & Hardware <input type="checkbox"/> SF Adjustable Slip Fitter with Angle Indicator <input type="checkbox"/> WG Wire Guard
KELVIN	<input type="checkbox"/> 3500K <input type="checkbox"/> 4100K			
	<input type="checkbox"/> MIA Made In America			

For Additional Accessories and Options Visit www.aslighting.com

ASL
25 Twelfth Street
Brooklyn, NY 11215-3820

Toll Free
Phone: 800-369-1101
Fax: 800-552-3465

Local
Phone: 718-369-1100
Fax: 718-369-1105

Online
email: info@aslighting.com
visit: www.aslighting.com



© copyright 2008 by American Scientific Lighting Corp. All rights reserved.

OFR