



# LED FIXTURE SPECIFICATION

MODEL # **BCM**



FINAL MODEL #			
PROJECT			
TYPE		AREA	
NOTES			

## STANDARD FEATURES: SCONCE/MINI PENDANT LED LAMP

Fixture thermally tested to ensure longevity  
 Maximum light distribution throughout lens  
 Over current/voltage short circuit protection  
 UL and/or CSA Compliant Listed  
 Constant Current Design

FIXTURE	LED ENGINE
<b>BASE</b> CR Steel Construction <b>FINISH</b> Silver <b>LENS</b> White Frosted Glass <b>LOCATION</b> Wet <b>COMPLIANT</b> <b>LIFE HOURS</b> 50,000 <b>WARRANTY</b> Limited 5 Years <b>ASSEMBLED IN AMERICA</b>	<b>LUMENS PER WATT</b> AVG 80-100 @Module Efficacy <b>KELVIN</b> 27K 30K 35K 40K 50K <b>CRI</b> 80+ <b>DRIVER</b> 120 VOLTS 50/60Hz <b>POWER FACTOR</b> Normal <b>TRIAC OR ELECTRONIC</b> Low Voltage Dimming Down To 5% With Wall Box Dimmers <b>TESTED</b> LM80 and LM82

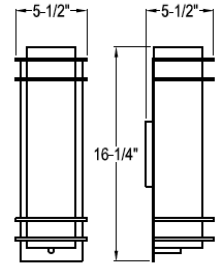

### LED LIGHT SOURCE OPTIONS\* ORDERING INFORMATION:

EXAMPLE

WATTAGE: 12	KELVIN: 3000k	SIZE: 5x2
-------------	---------------	-----------

SIZE OPTIONS
D5 1/2 W5 1/2 H16 1/4

WATTAGE:	KELVIN:	SIZE:
----------	---------	-------

<b>2700K WARM WHITE</b>	<b>3000K SOFT WHITE</b>	<b>3500K NEUTRAL</b>	<b>4000K COOL WHITE</b>	<b>5000K DAYLIGHT</b>
-------------------------	-------------------------	----------------------	-------------------------	-----------------------

BASE	LED GU24 BULB / MEDIUM BULB			
SYSTEM WATTAGE	6	9	12	

## SPECIAL OPTIONS (please specify if applicable)

EXAMPLE

DRIVER: DVD	FINISH: FCU	LENS: LCU	ACCESSORIES: FUS	TECHNOLOGY: CT
-------------	-------------	-----------	------------------	----------------

DRIVER:	FINISH:	LENS:	ACCESSORIES:	TECHNOLOGY:
---------	---------	-------	--------------	-------------

DRIVER	FINISH	LENS	ACCESSORIES	TECHNOLOGY
<b>STANDARD PRODUCT COMES: 120 VOLT (TRIAC DIMMABLE)</b>  <input type="checkbox"/> DV 120/277 (Non Dimmable)	<input type="checkbox"/> FB Black <input type="checkbox"/> FBR Bronzestone <input type="checkbox"/> FCU Custom Any RAL Finish <input type="checkbox"/> FSN Satin Nickel <input type="checkbox"/> FW White	<input type="checkbox"/> LCU Custom	<input type="checkbox"/> BBX Back Box (Conduit Holes Optional) <input type="checkbox"/> FUS Fused <input type="checkbox"/> IB Individually Boxed <input type="checkbox"/> PCH Pull Chain <input type="checkbox"/> PS Pin Switch <input type="checkbox"/> SRP Surge Protector	<input type="checkbox"/> CT LED Color Tuning <input type="checkbox"/> PC Photo Control <input type="checkbox"/> EMGR Emergency Remote <input type="checkbox"/> TP Tamper Proof Screws

